

Ultra Sonic Knives

IPK – Catalogue 2023/24



**KEEPS YOU
AHEAD**



Corporate Motto: "Respect the Divine and Love People"

敬天愛人

Preserve the spirit to work fairly and honorably,
respecting people, our work, our company
and our global community.

THE NEW VALUE FRONTIER



"The New Value Frontier" reflects Kyocera's commitment to continuously creating new value at the cutting edge of technology. The global Kyocera Group develops unique technologies and applies its vision to create valuable products that the markets continually seek.



Development of precision cutting tools at the highest level

Striving for continuous improvement in order to meet the requirements of our customers and, of course, our own demands is one of the standards that drives us forward in the company.

The seal »Made in Germany« has long stood for quality, and this applies to our carbide products to the full extent. Carbide knives for cutting tables or plotters from Zünd, Roland, Aristo, XYZ, Bullmer, Mimaki, Graphtec, Summa, Multicam, Esko Kongsberg, Ecocam, Kuris, Gerber, Mutoh, etc. are part of our product portfolio – just like special milling cutters for chip cards, engraving cutters, double-edged milling cutters, milling cutters with right or left swirl.

Ultrasonic knives for AGFM and Dukane or for applications in CFRP, honeycomb etc. round off our wide range of standard products.

Another special area is knives and milling cutters tailored to customer-specific requirements.

You have a challenge, we have the solution. Carbide knives with the geometry according to the respective requirement up to 330 mm are no problem.

Carbide specification

Hardness [HV30]	1660 ⁺⁵⁰ ₋₀
Granulation [µm]	Fine 1,1 – 1,4
Binder	Cobalt

The carbide specification are the following for our standard goods. Other specifications can be requested at any time on inspection.

Ultra Sonic Knives

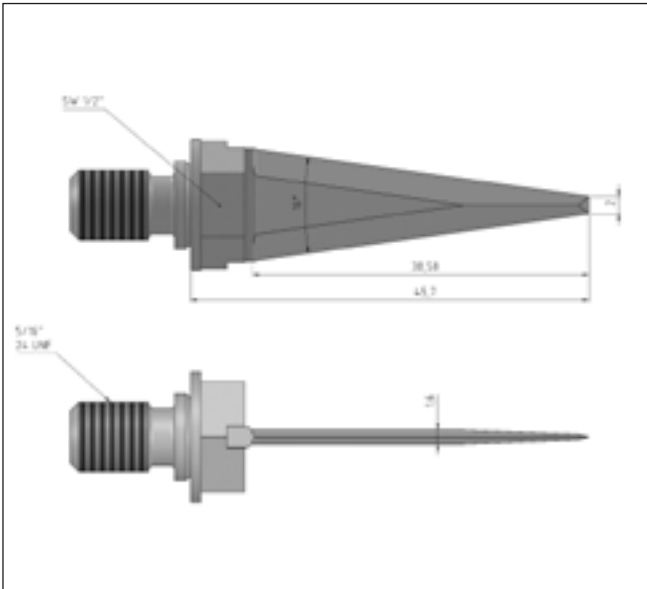

KY-630003

- Comparable with:
AGFM UET 16.02, Dukane UFF-DUK 62

Additional information

Overall length	45,0 mm
Thread	5/16" – 24 UNF
Cutting length	38,0 mm
Cutting angle	82°
Geometry	2 edges, Double cutting edge

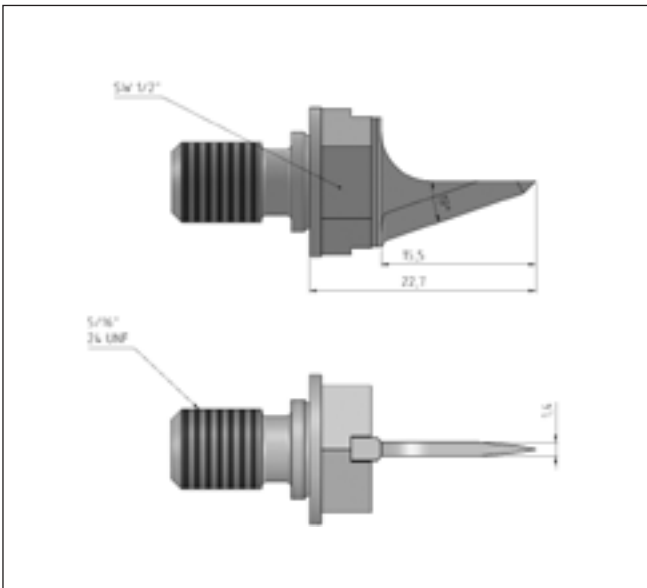

KY-630004

- Comparable with:
AGFM UET 19.00

Additional information

Overall length	22,0 mm
Thread	5/16" – 24UNF
Cutting length	15,0 mm
Cutting angle	71°
Geometry	2 edges

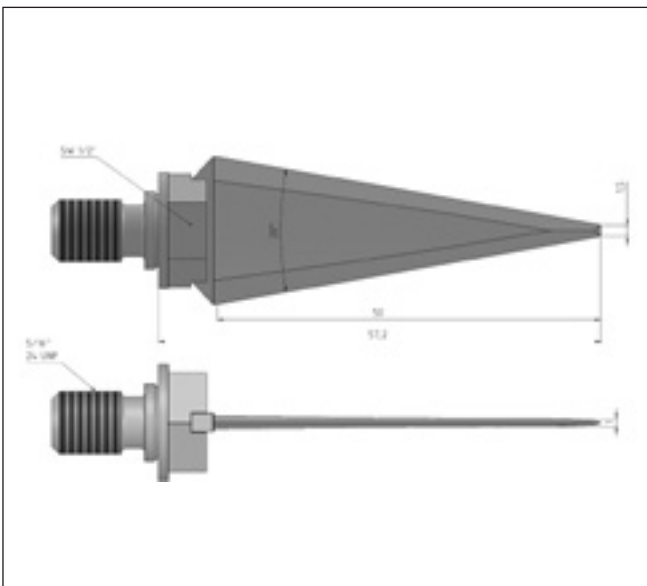

KY-630005

- Comparable with:
AGFM UET 20.00

Additional information

Overall length	57,0 mm
Thread	5/16" – 24UNF
Cutting length	50,0 mm
Cutting angle	70°
Geometry	2 edges, Double cutting edge

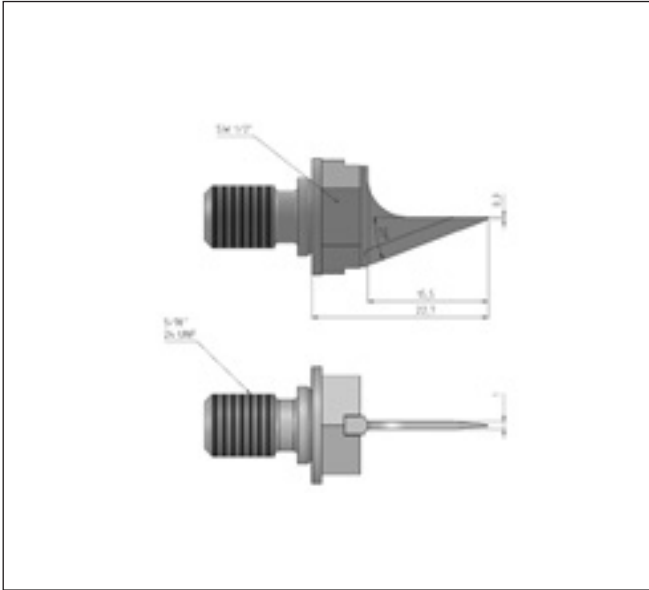

KY-630006

- Comparable with:
AGFM UET 21.01

Additional information

Overall length	22,0 mm
Thread	5/16" – 24UNF
Cutting length	15,0 mm
Cutting angle	69°
Geometry	2 edges

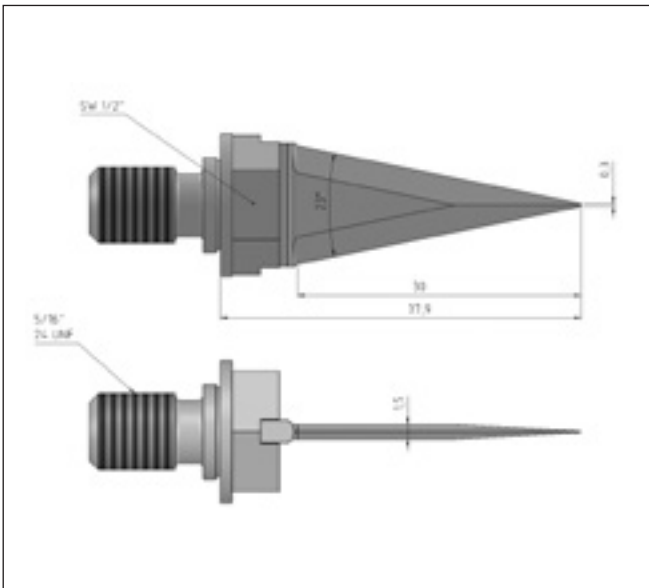

KY-630007

- Comparable with:
AGFM UET 23.01

Additional information

Overall length	37,2 mm
Thread	5/16" – 24UNF
Cutting length	30,0 mm
Cutting angle	78,5°
Geometry	2 edges, Double cutting edge

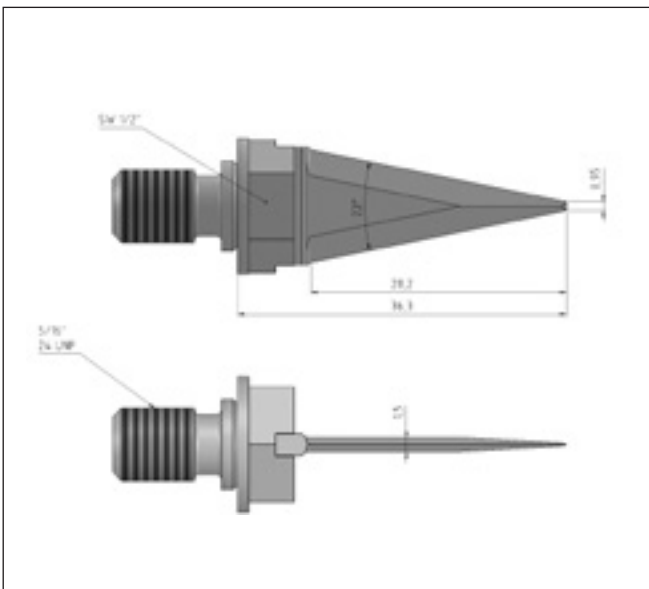

KY-630008

- Comparable with:
AGFM UET 23.02, Dukane UFF-DUK 58

Additional information

Overall length	35,6 mm
Thread	5/16" – 24UNF
Cutting length	28,5mm
Cutting angle	78,5°
Geometry	2 edges, Double cutting edge

Ultra Sonic Knives

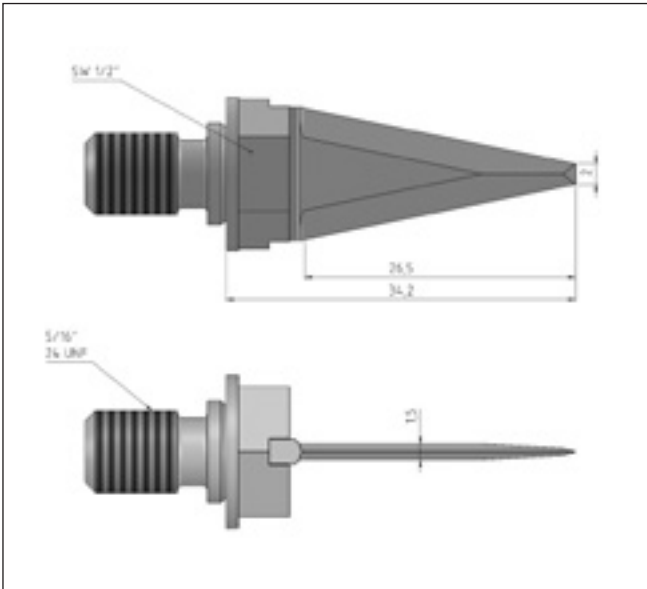

KY-630009

- Comparable with:
AGFM UET 23.03

Additional information

Overall length	33,5 mm
Thread	5/16" – 24UNF
Cutting length	26,5 mm
Cutting angle	78,5°
Geometry	2 edges, Double cutting edge

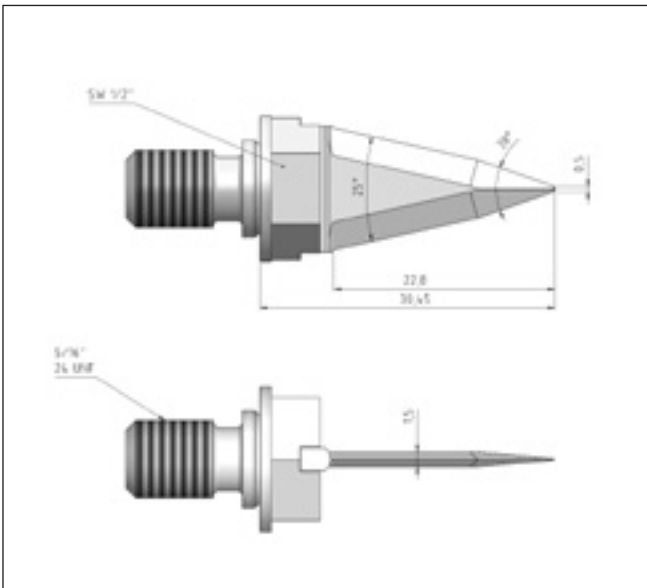

KY-630010

- Comparable with:
AGFM UET 25.06

Additional information

Overall length	29,7 mm
Thread	5/16" – 24UNF
Cutting length	23,0 mm
Cutting angle	71°
Geometry	3 edges, Double cutting edge

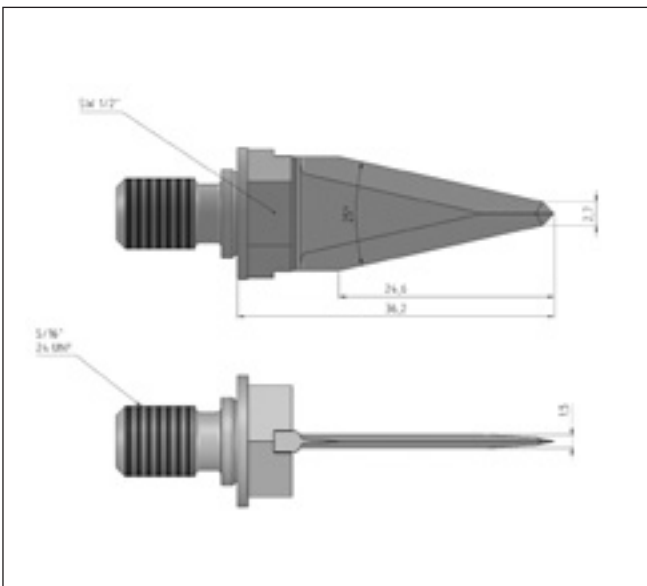

KY-630011

- Comparable with:
AGFM UET 25.07

Additional information

Overall length	36,0 mm
Thread	5/16" – 24UNF
Cutting length	24,5 mm
Cutting angle	77,5°
Geometry	2 edges, Double cutting edge

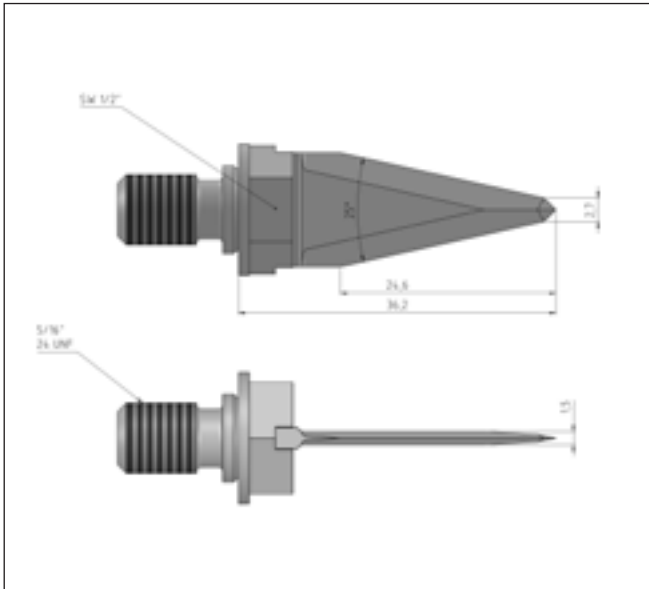

KY-630012

- Comparable with:
AGFM UET 35.01, Dukane UFF-DUK 8

Additional information

Overall length	17,0 mm
Thread	5/16" – 24UNF
Cutting length	9,6 mm
Cutting angle	72,5°
Geometry	2 edges, Double cutting edge

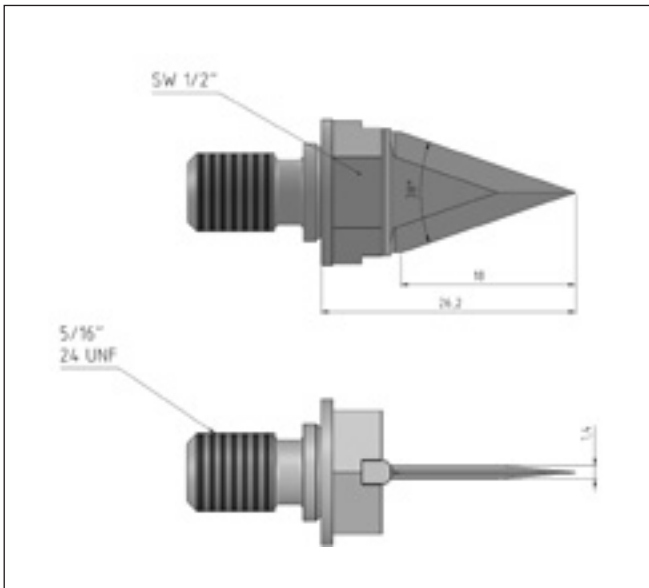

KY-630013

- Comparable with:
AGFM UET 38.00, Dukane UFF-DUK 53

Additional information

Overall length	25,5 mm
Thread	5/16" – 24UNF
Cutting length	18,0 mm
Cutting angle	71°
Geometry	1 edge, Double cutting edge

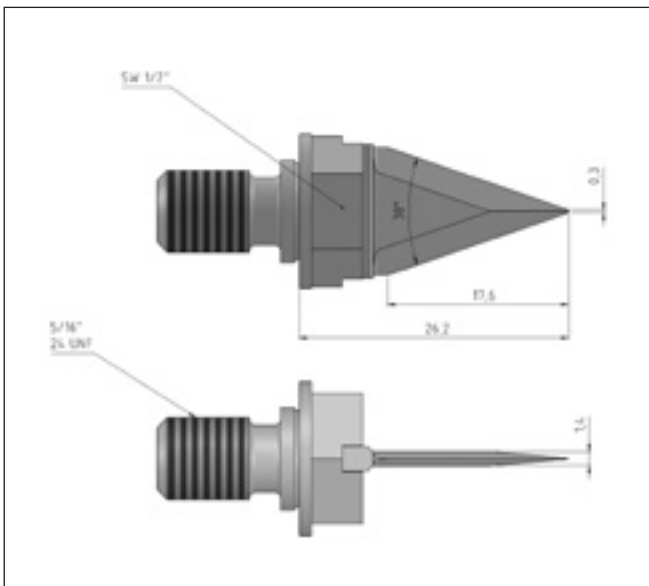

KY-630014

- Comparable with:
AGFM UET 38.01, Dukane UFF-DUK 65

Additional information

Overall length	25,5 mm
Thread	5/16" – 24UNF
Cutting length	17,6 mm
Cutting angle	71°
Geometry	2 edges, Double cutting edge

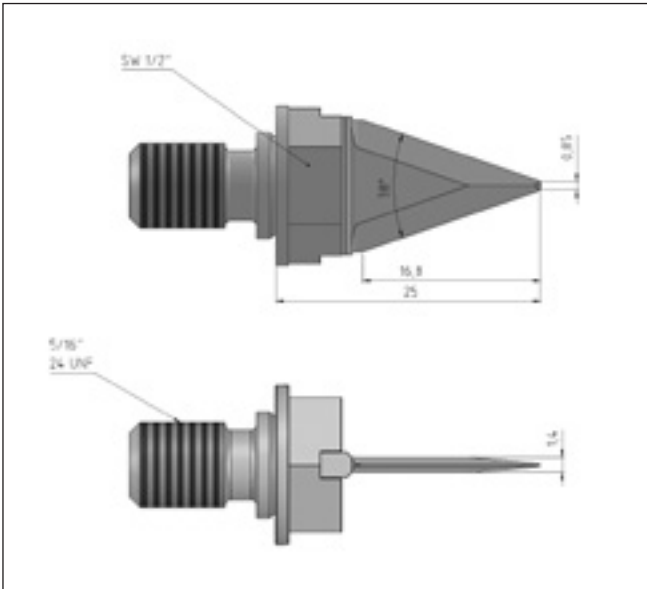

KY-630015

- Comparable with:
AGFM UET 38.02

Additional information

Overall length	24,3 mm
Thread	5/16" – 24UNF
Cutting length	16,8 mm
Cutting angle	71°
Geometry	2 edges, Double cutting edge

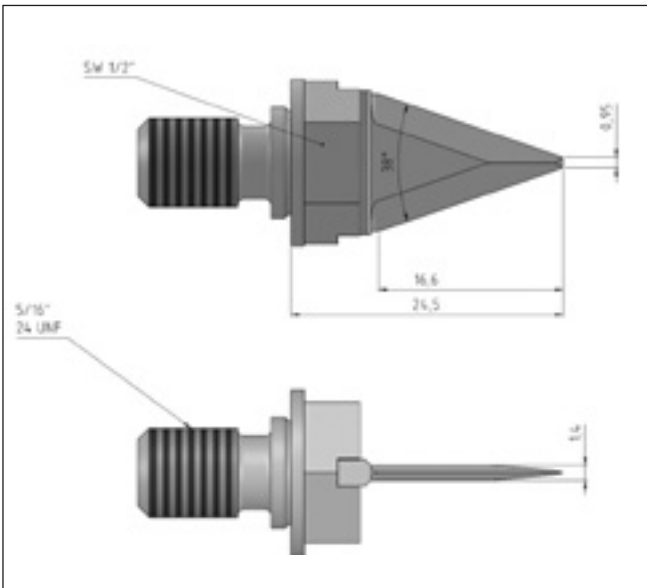

KY-630016

- Comparable with:
AGFM UET 38.03

Additional information

Overall length	23,8 mm
Thread	5/16" – 24UNF
Cutting length	16,6 mm
Cutting angle	71°
Geometry	2 edges, Double cutting edge

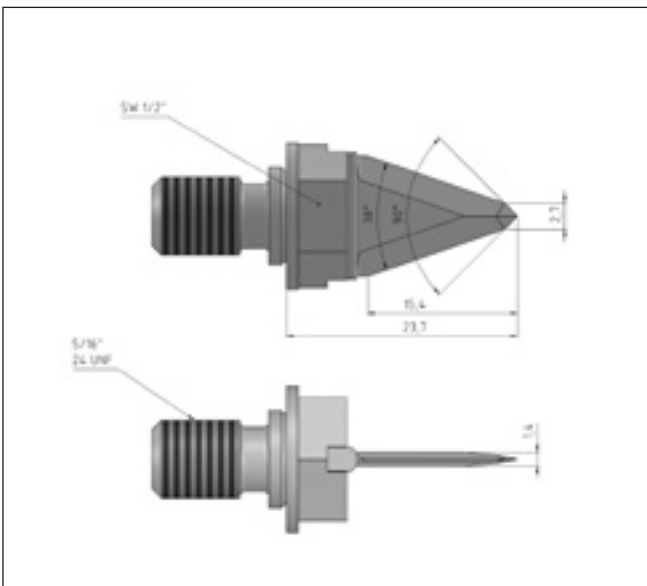

KY-630017

- Comparable with:
AGFM UET 38.04

Additional information

Overall length	23,0 mm
Thread	5/16" – 24UNF
Cutting length	15,4 mm
Cutting angle	71°
Geometry	2 edges, Double cutting edge

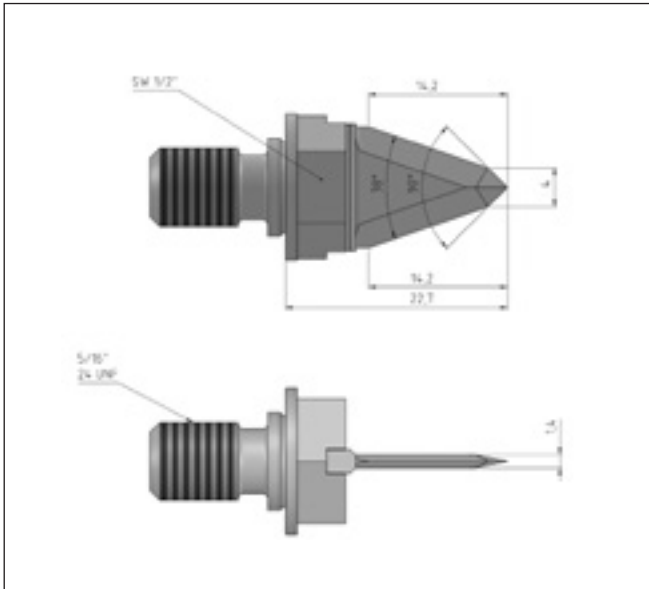

KY-630018

- Comparable with:
AGFM UET 38.05, Dukane UFF-DUK 59

Additional information

Overall length	23,0 mm
Thread	5/16" – 24UNF
Cutting length	15,5 mm
Cutting angle	71°
Geometry	2 edges, Double cutting edge

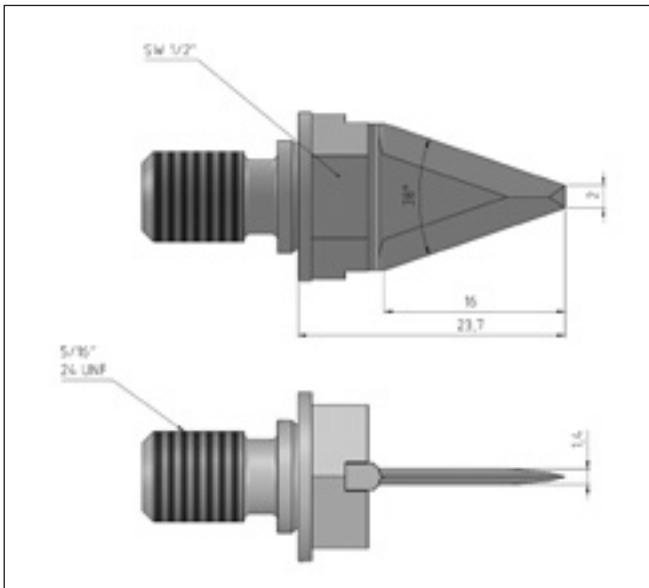

KY-630019

- Comparable with:
AGFM UET 38.06

Additional information

Overall length	23,0 mm
Thread	5/16" – 24UNF
Cutting length	15,5 mm
Cutting angle	71°
Geometry	2 edges, Double cutting edge

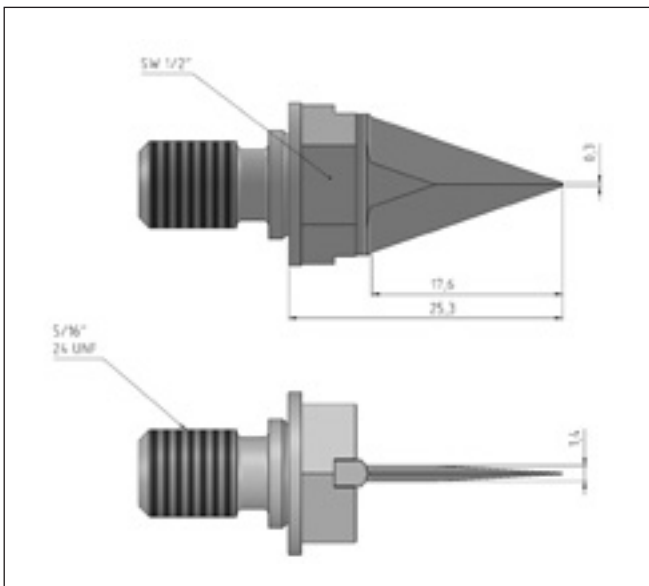

KY-630020

- Comparable with:
AGFM UET 38.10

Additional information

Overall length	25,5 mm
Thread	5/16" – 24UNF
Cutting length	17,6 mm
Cutting angle	71°
Geometry	2 edges, Double cutting edge

Ultra Sonic Knives

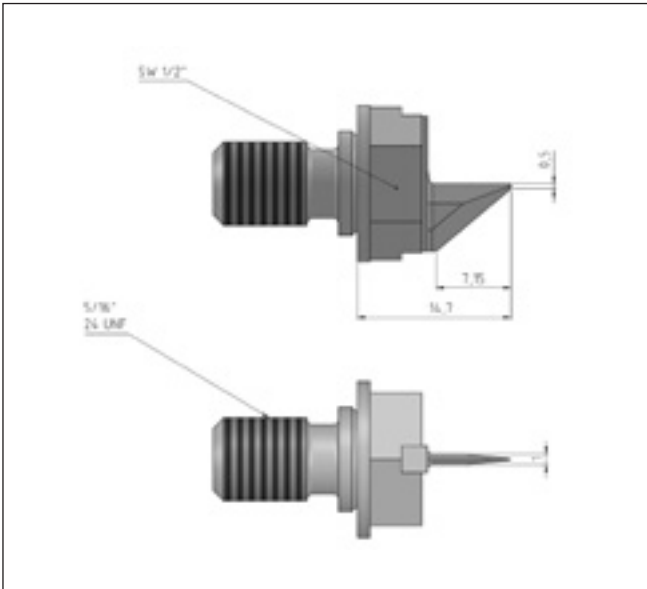

KY-630021

- Comparable with:
AGFM UET 40.02

Additional information

Overall length	14,7 mm
Thread	5/16" – 24UNF
Cutting length	7,5 mm
Cutting angle	50°
Geometry	2 edges

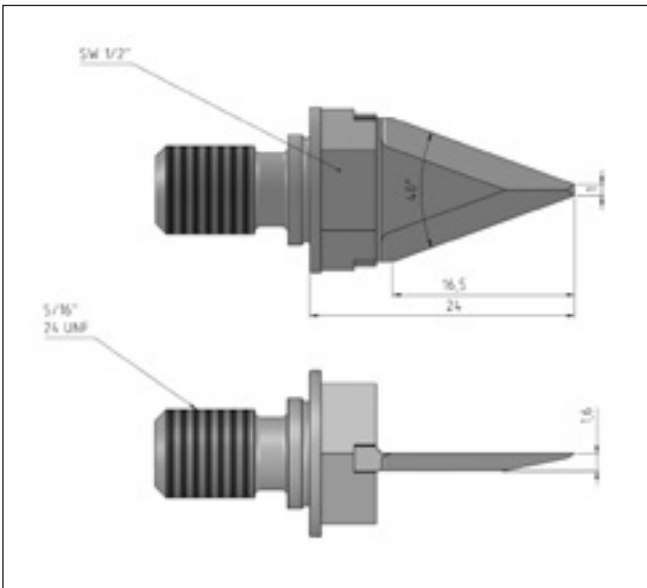

KY-630022

- Comparable with:
AGFM UET 40.04

Additional information

Overall length	24 mm
Thread	5/16" – 24UNF
Cutting length	16,5 mm
Cutting angle	70°
Geometry	2 edges, Double cutting edge

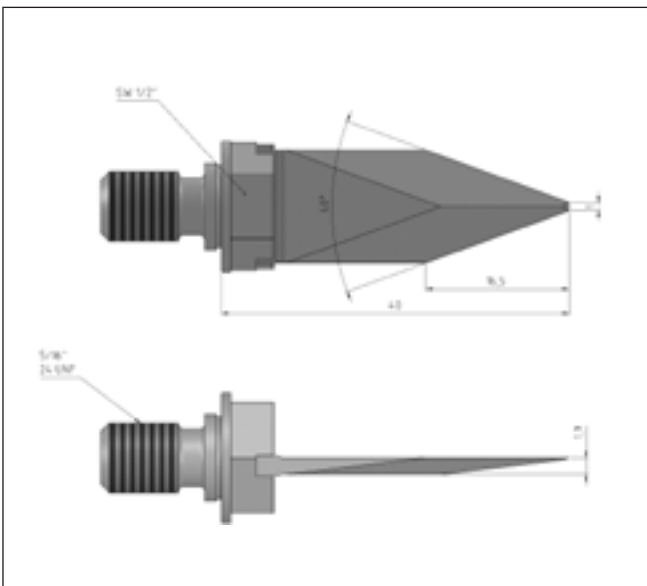

KY-630023

- Comparable with:
AGFM UET 40.05

Additional information

Overall length	40,0 mm
Thread	5/16" – 24UNF
Cutting length	16,5 mm
Cutting angle	70°
Geometry	2 edges, Double cutting edge

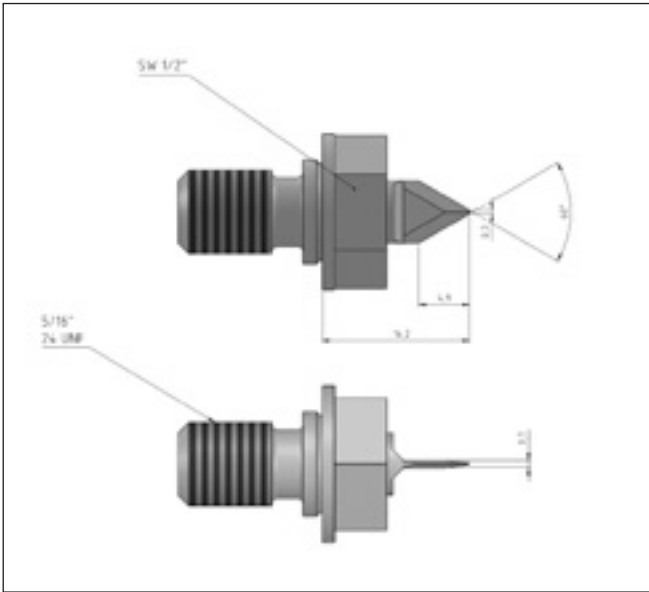

KY-630024

- Comparable with:
AGFM UET 60.04

Additional information

Overall length	14,0 mm
Thread	5/16" – 24UNF
Cutting length	4,9 mm
Cutting angle	60°
Geometry	2 edges, Double cutting edge

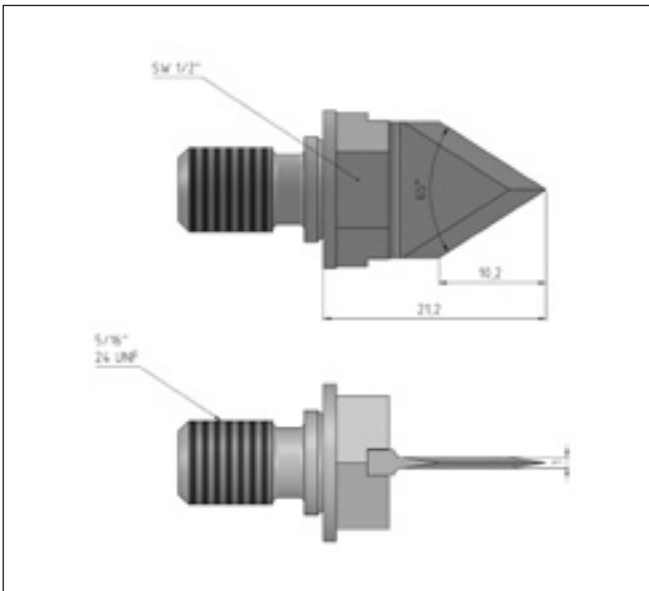

KY-630025

- Comparable with:
AGFM UET 65.00

Additional information

Overall length	21,0 mm
Thread	5/16" – 24UNF
Cutting length	10,0 mm
Cutting angle	57,5°
Geometry	1 edge, Double cutting edge

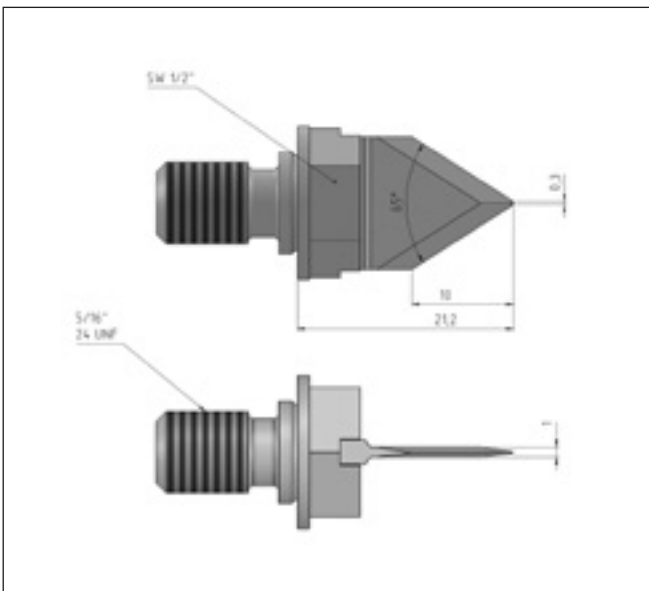

KY-630026

- Comparable with:
AGFM UET 65.01

Additional information

Overall length	21,0 mm
Thread	5/16" – 24UNF
Cutting length	10,0 mm
Cutting angle	57,5°
Geometry	2 edges, Double cutting edge

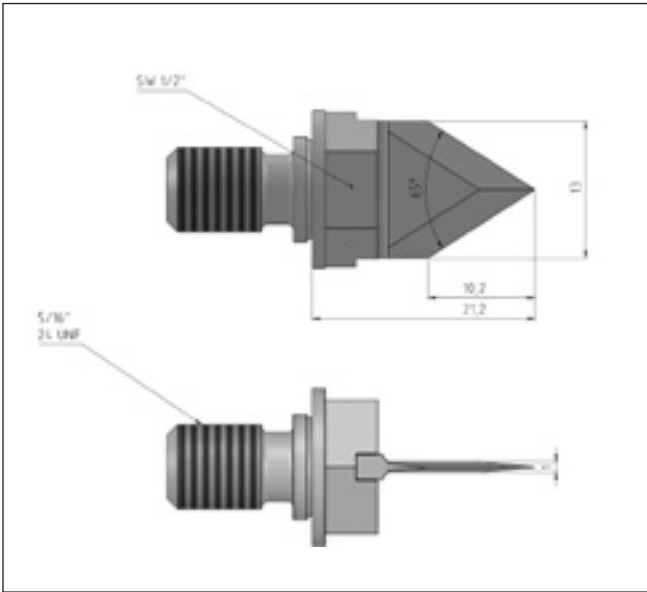

KY-630027

- Comparable with:
AGFM UET 65.02

Additional information

Overall length	21,0 mm
Thread	5/16" – 24UNF
Cutting length	10,0 mm
Cutting angle	57,5°
Geometry	1 edge, Double cutting edge

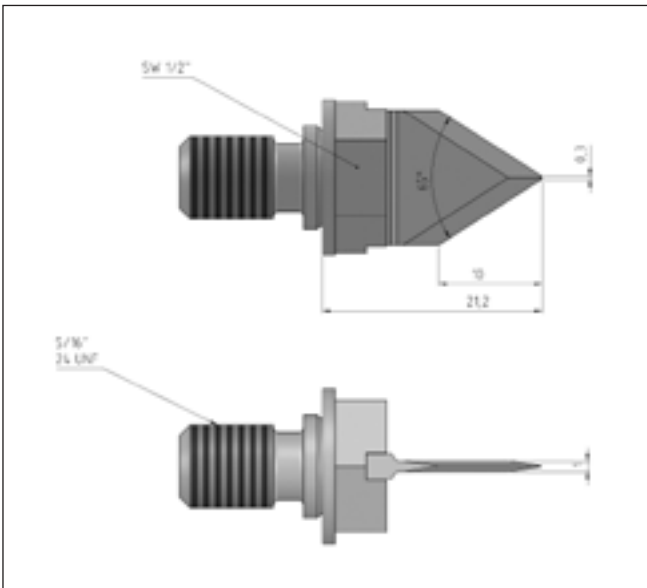

KY-630028

- Comparable with:
AGFM UET 65.03

Additional information

Overall length	21,0 mm
Thread	5/16" – 24UNF
Cutting length	10,0 mm
Cutting angle	57,5°
Geometry	2 edges, Double cutting edge

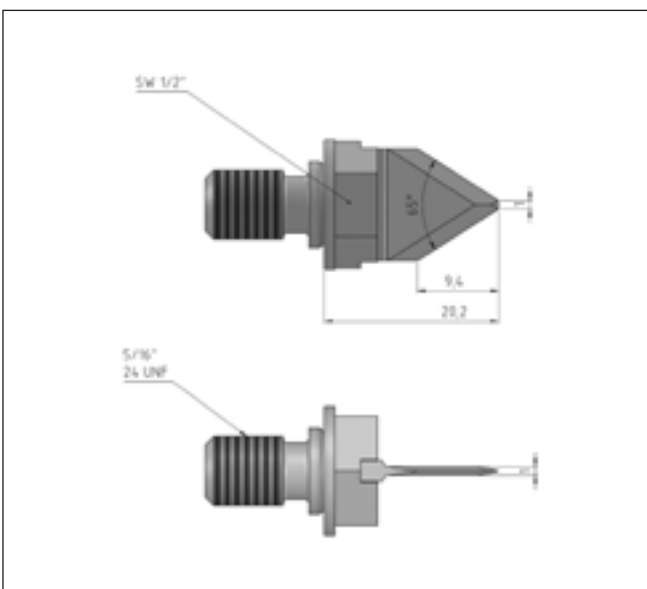

KY-630029

- Comparable with:
AGFM UET 65.04

Additional information

Overall length	20,0 mm
Thread	5/16" – 24UNF
Cutting length	9,4 mm
Cutting angle	57,5°
Geometry	2 edges, Double cutting edge

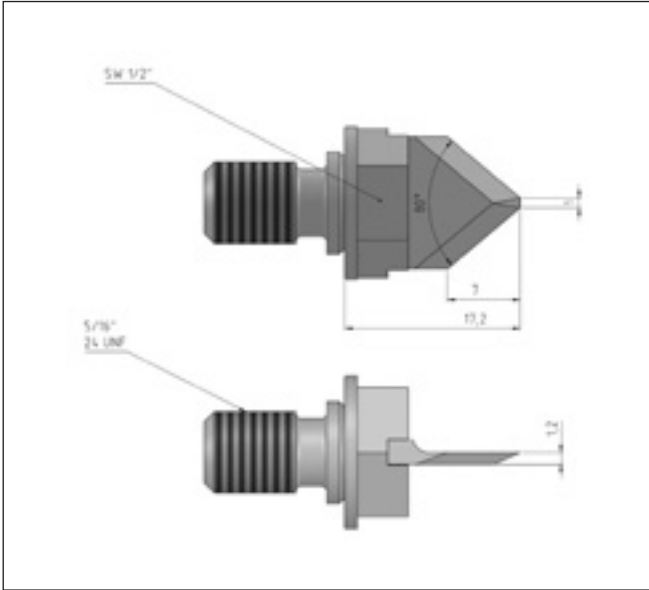

KY-630030

- Comparable with:
AGFM UET 80.00

Additional information

Overall length	16,5 mm
Thread	5/16" – 24UNF
Cutting length	7,0 mm
Cutting angle	50°
Geometry	2 edges, Double cutting edge

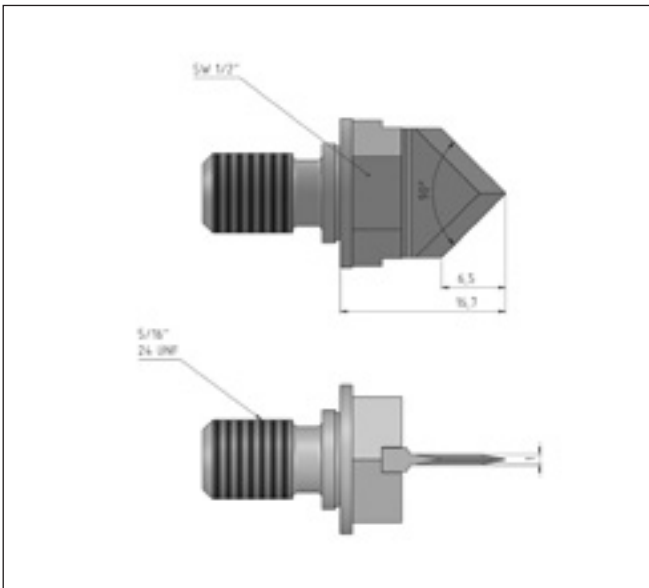

KY-630031

- Comparable with:
AGFM UET 90.00

Additional information

Overall length	16,5 mm
Thread	5/16" – 24UNF
Cutting length	6,5 mm
Cutting angle	45°
Geometry	1 edge, Double cutting edge

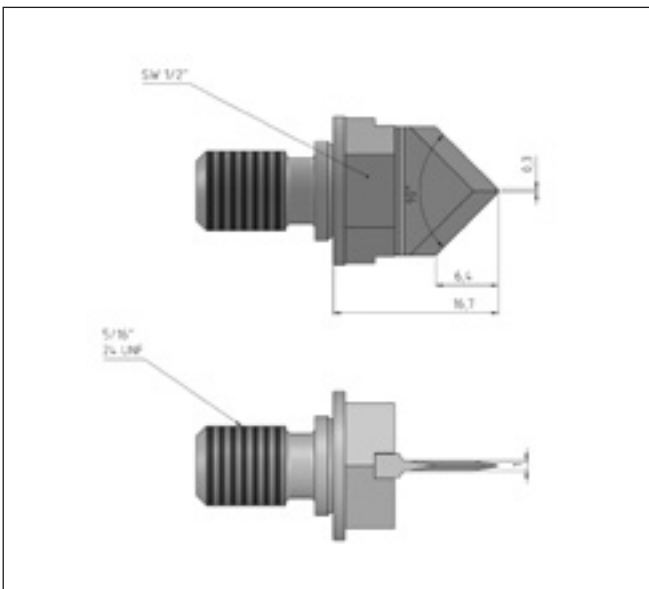

KY-630032

- Comparable with:
AGFM UET 90.01

Additional information

Overall length	16,5 mm
Thread	5/16" – 24UNF
Cutting length	6,2 mm
Cutting angle	45°
Geometry	2 edges, Double cutting edge

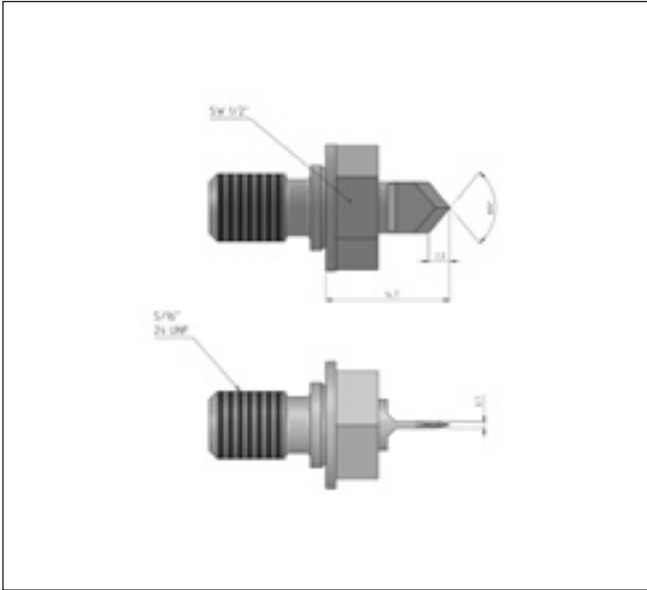

KY-630034

- Comparable with:
AGFM UET 100.00

Additional information

Overall length	14,5 mm
Thread	5/16" – 24UNF
Cutting length	2,5 mm
Cutting angle	40°
Geometry	1 edge, Double cutting edge

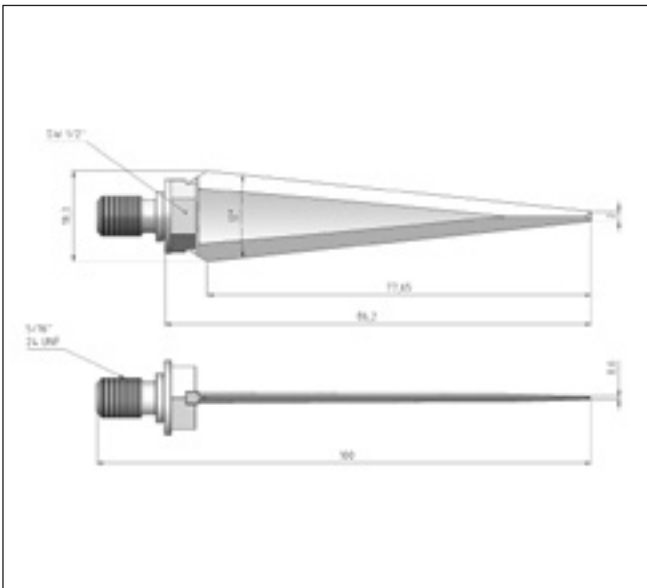

KY-630038

- Special

Additional information

Overall length	86,2 mm
Thread	5/16" – 24UNF
Cutting length	27,65 mm
Cutting angle	12°
Geometry	2 edges, Double cutting edge

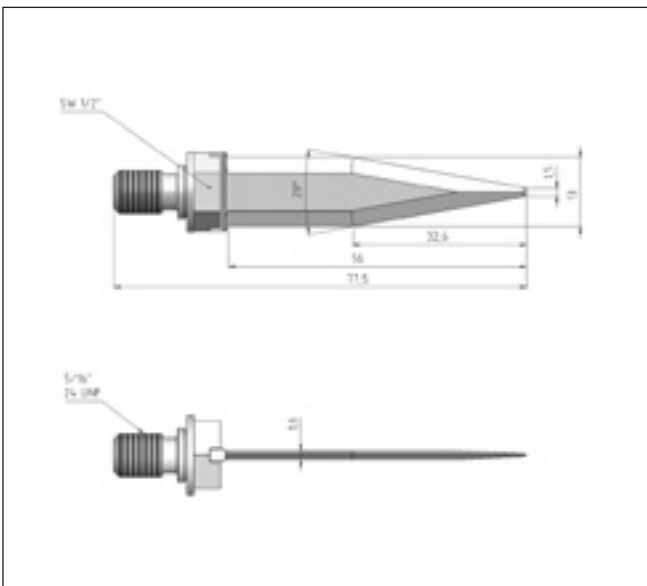

KY-630039

- Special

Additional information

Overall length	56 mm
Thread	5/16" – 24UNF
Cutting length	56 mm
Cutting angle	20°
Geometry	2 edges, Double cutting edge

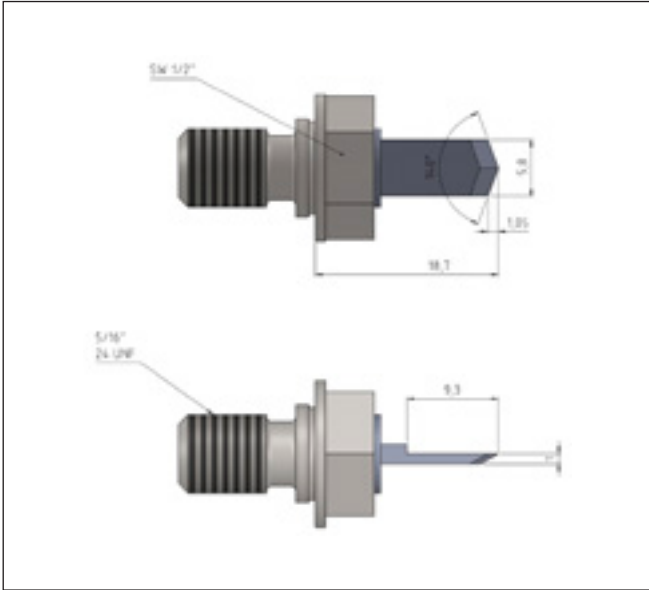

KY-630043

- Comparable with:
AGFM UFF-DUKPA140

Additional information

Overall length	18,7 mm
Thread	5/16" – 24UNF
Cutting length	1,05 mm
Cutting angle	20°
Geometry	1 edge, Double cutting edge

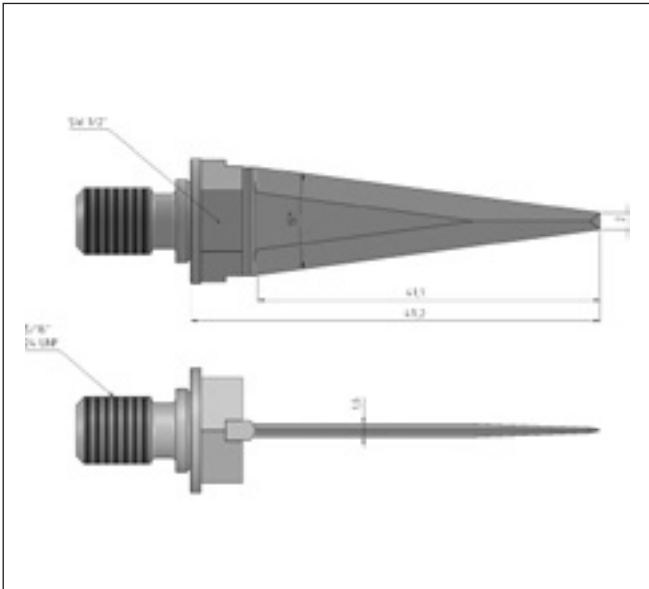

KY-630044

- Special

Additional information

Overall length	48,5 mm
Thread	5/16" – 24UNF
Cutting length	41,0 mm
Cutting angle	82,5°
Geometry	2 edges, Double cutting edge

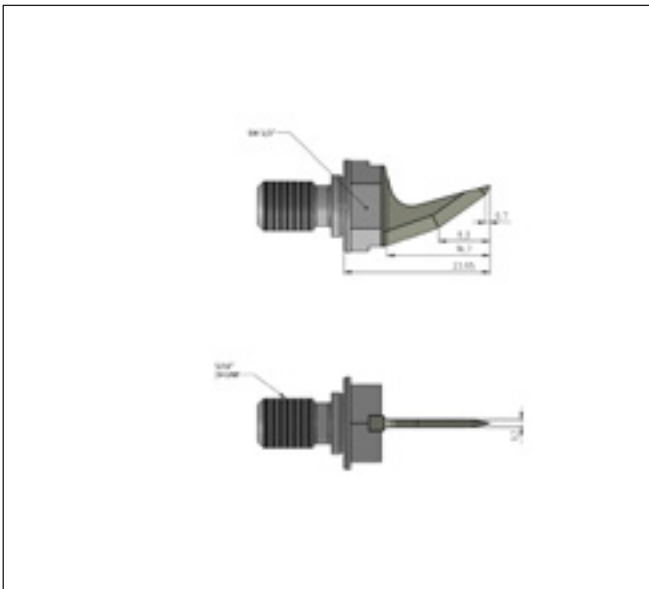

KY-630070

- Special

Additional information

Overall length	23,65 mm
Thread	5/16" – 24UNF
Cutting length	16,7 mm
Cutting angle	69°
Geometry	2 edges

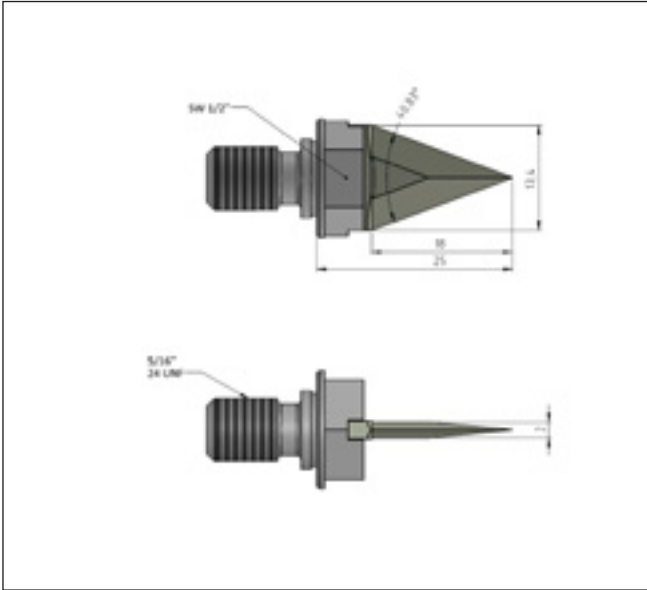

KY-630071

■ Special

Additional information

Overall length	25 mm
Thread	5/16" – 24UNF
Cutting length	18 mm
Cutting angle	40,83°
Geometry	2 edges, Double cutting edge

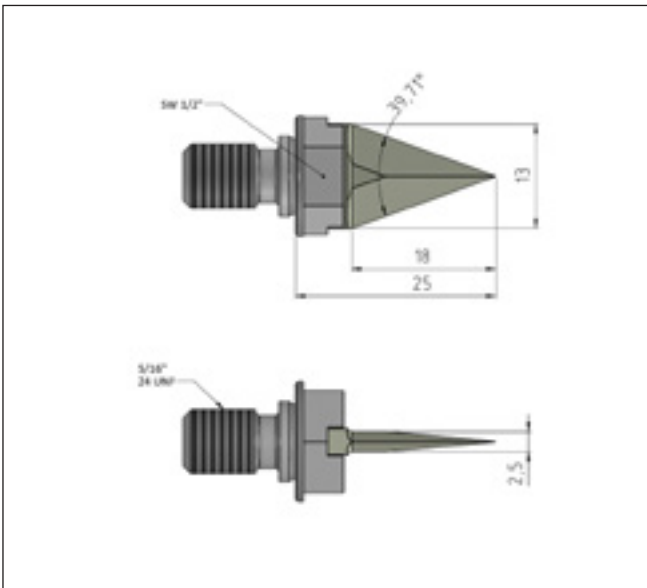

KY-630072

■ Special

Additional information

Overall length	25 mm
Thread	5/16" – 24UNF
Cutting length	18 mm
Cutting angle	39,71°
Geometry	2 edges, Double cutting edge

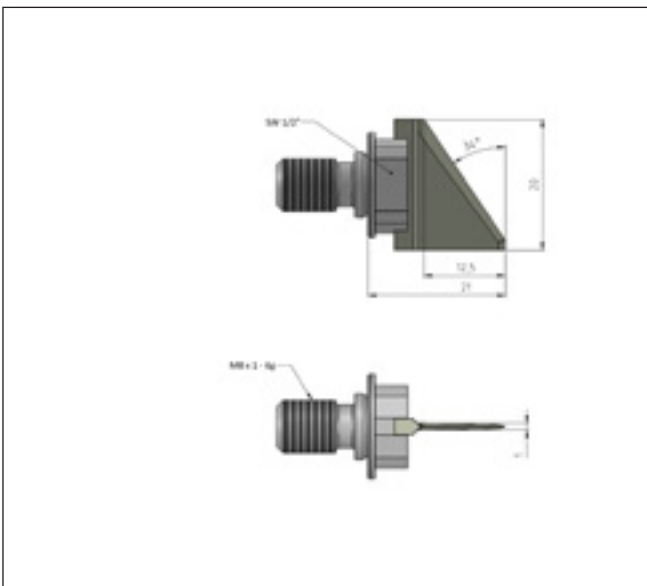

KY-630103

■ Special

Additional information

Overall length	21 mm
Thread	M8x1-6g
Cutting length	12,5 mm
Cutting angle	34°
Geometry	1 edgen, Double cutting edge

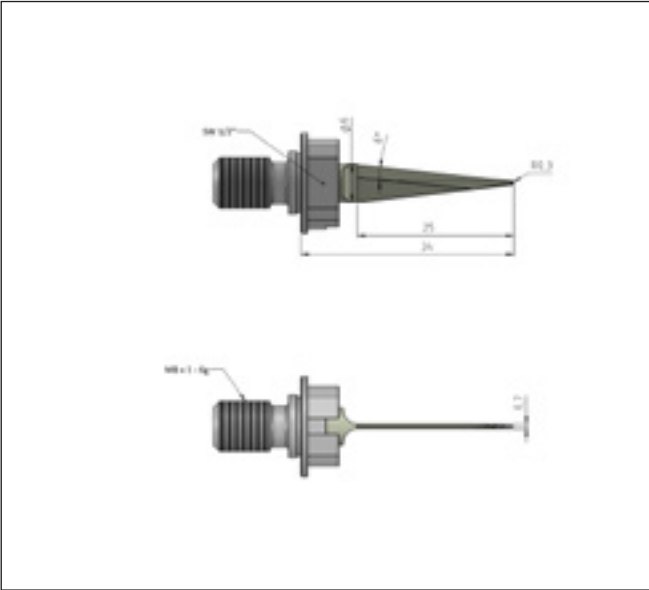

KY-630104

■ Special

Additional information

Overall length	34 mm
Thread	M8x1-6g
Cutting length	25 mm
Cutting angle	6°
Geometry	1 edgen, Double cutting edge

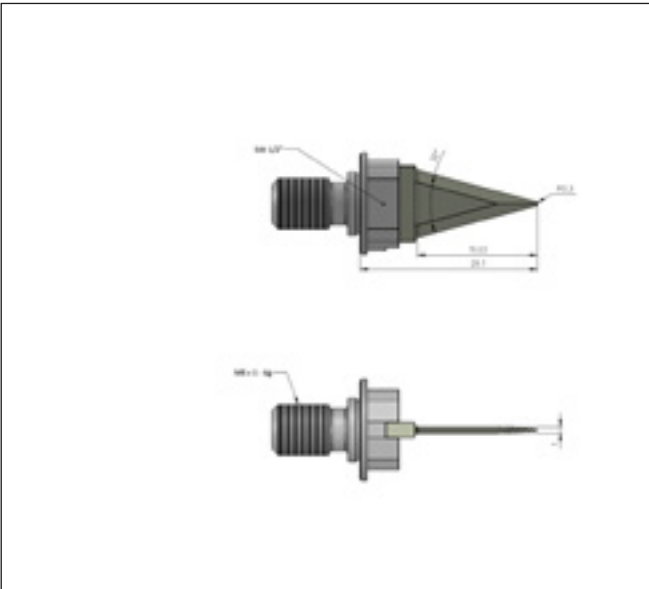

KY-630216

■ Special

Additional information

Overall length	29,1 mm
Thread	5/16" – 24UNF
Cutting length	19,03 mm
Cutting angle	30°
Geometry	2 edges, Double cutting edge

My sketch

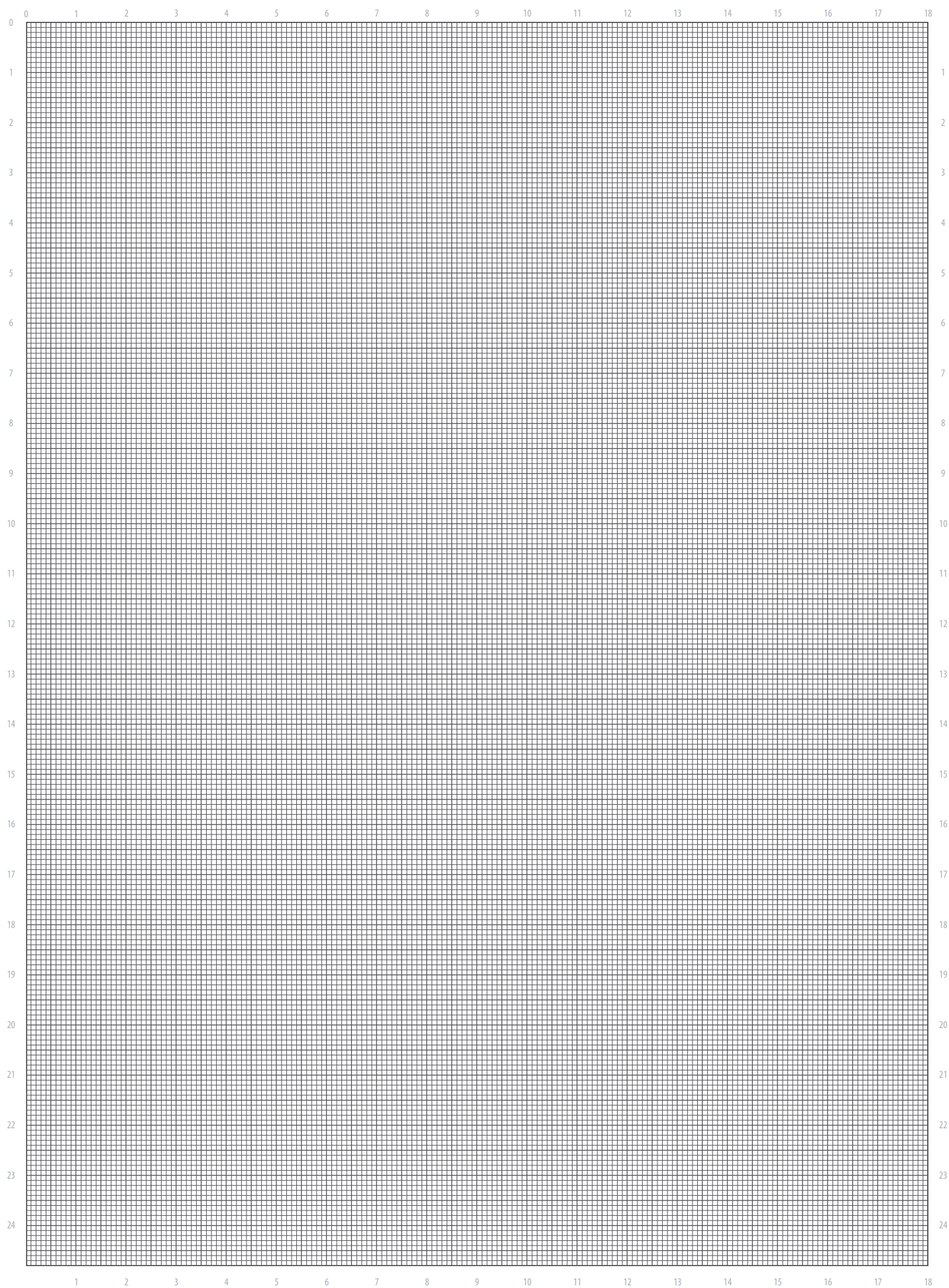

WE KNOW IT'S ALL ABOUT UNDERSTANDING REAL LIFE TO
ENGINEER THE RIGHT SOLUTION, THAT...

***KEEPS YOU
AHEAD***



www.kyocera-unimerco.com

© KYOCERA UNIMERCO 05.24 061_1140_PM_ML_ML

